

ALV SERIES

HIGH STRENGTH ALUMINUM LINE UP VISE

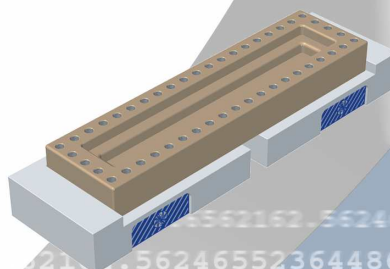
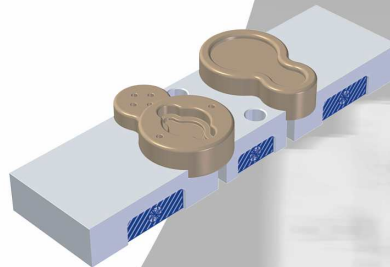
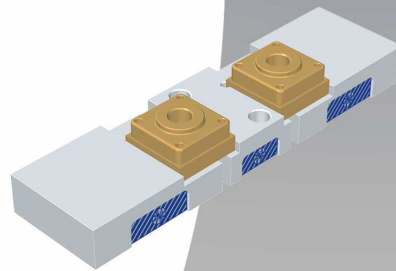

HIGH STRENGTH ALUMINUM LINE UP VISE HIGH STRENGTH ALUMINUM LINE UP VISE

We are pleased to present to you our newly designed ALV Vise series. Many new features have been added to streamline the work holding process. The ALV vise will optimize your workspace, speed up cycle time and will give an overall increase in production. We have added quick change snap-in jaws and a rapid 1 part - 2 part change over system. As an added feature all internal parts are sealed to prevent chip contamination.

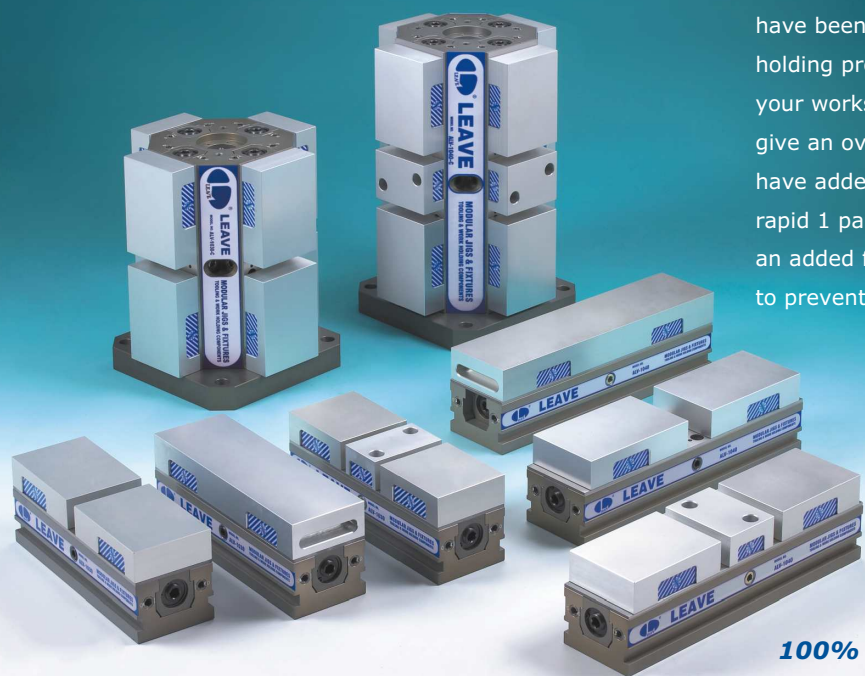

**LOWEST COST
HIGHEST QUALITY
100% SATISFACTION GUARANTEE**

Clamping Examples

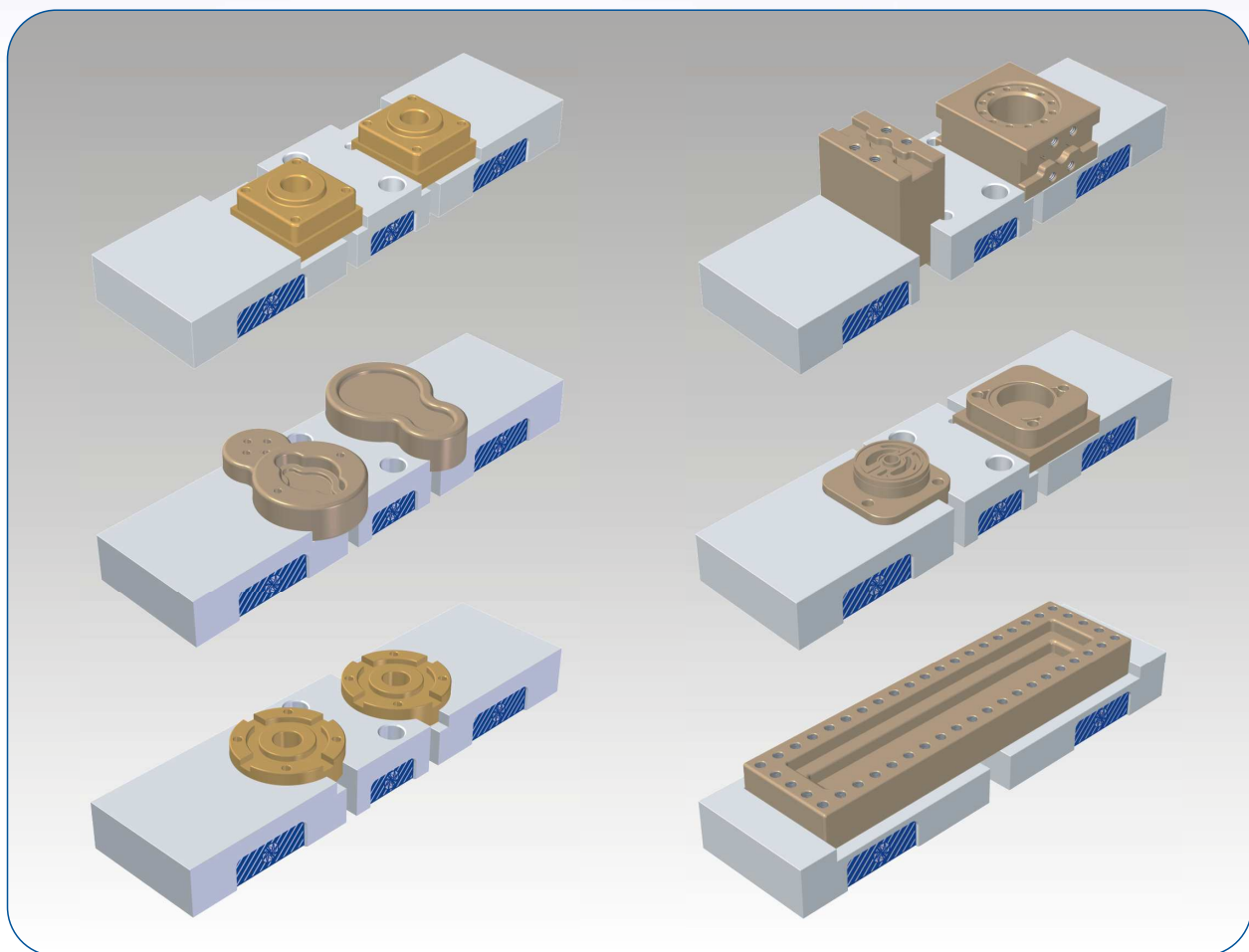

To Clamp Two Workpiece

1 Replace the pin-screw which is in the center with screw.

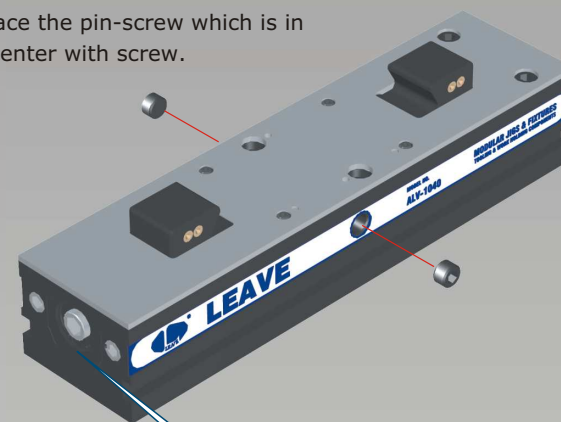

2 Turn counterclockwise the bolt to the end and turn the model to "I" which is on the side of the main body.

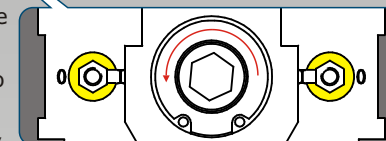

3 Install the fixed soft jaw and close it completely.

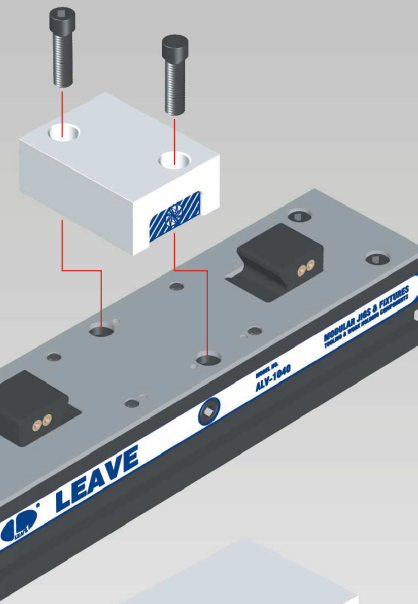

4 Align the slip way and the ball inside the moveable soft jaw.

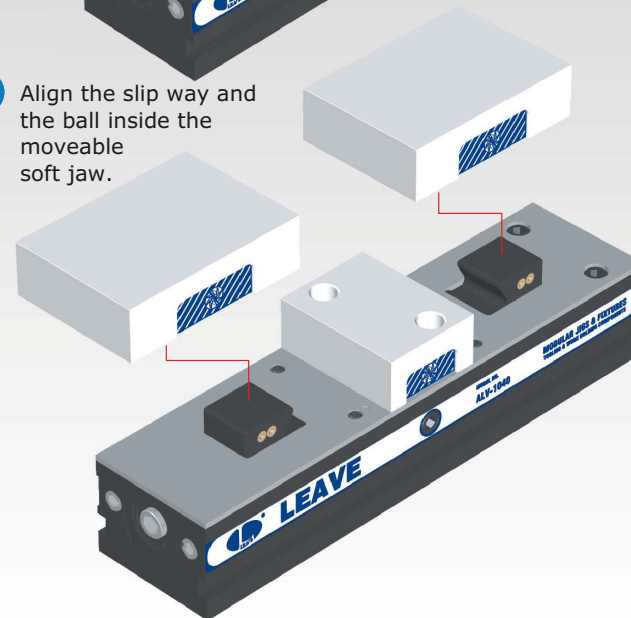

5 Press the moveable soft jaw until you hear the "click" sound.

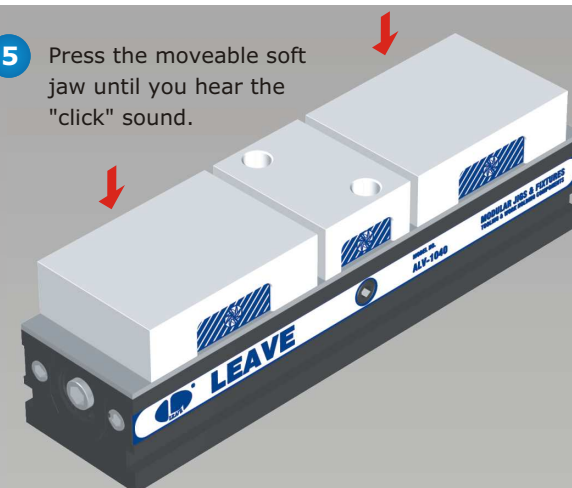

6 Move the moveable soft jaw according to the arrow pointing direction until you hear the "click".

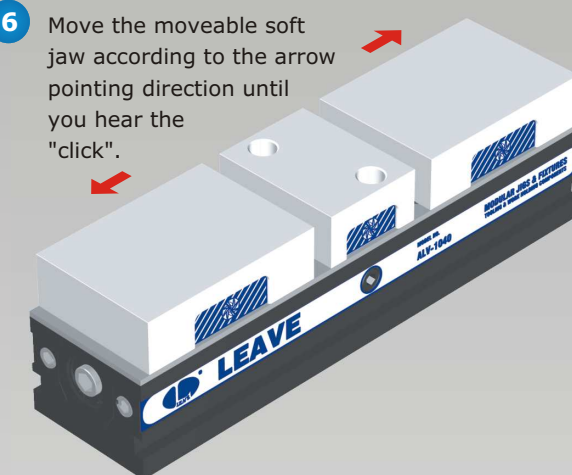

7 After making the soft jaw to the shape you want, fasten the first workpiece tightly by turning clockwise the bolt.

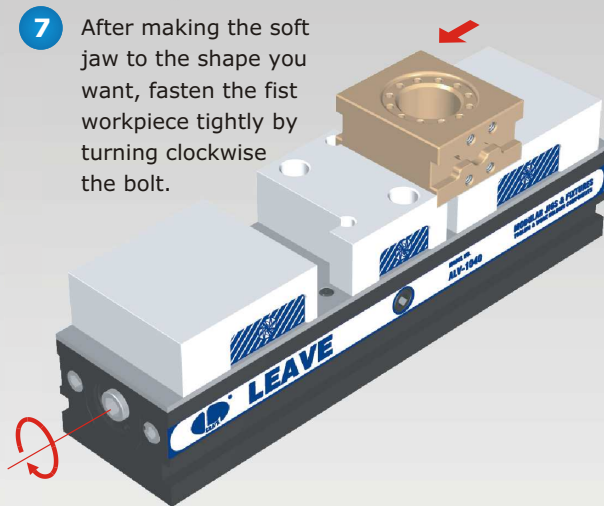

8 Put the second workpiece then swivel the bolt until it gets tightened.

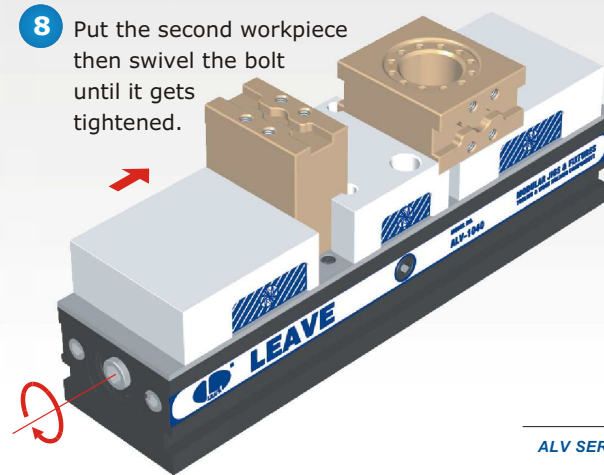

BP

BPA

BC

CP

SU

PT

SVF

ALV

OK-
VISE

OTHER

Column
for
Technical
Data

ALV HIGH STRENGTH ALUMINUM LINE UP VISE

To Clamp One Workpiece

1 Turn the model to "O" which is on the side of the main body.

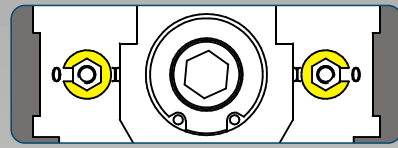

2 Turn counterclockwise the bolt to the end and replace the screw with pin-screw.

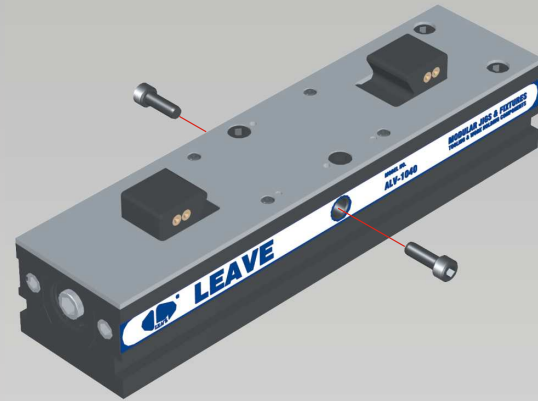

3 Align the slip way and the ball inside the moveable soft jaw.

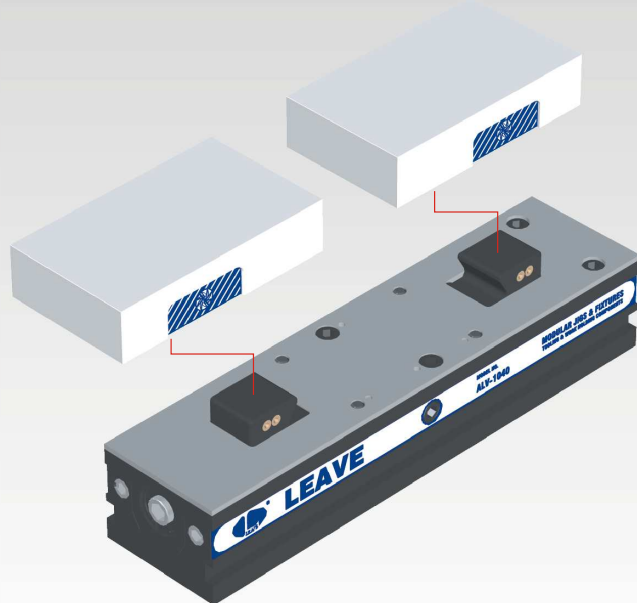

4 Press the moveable soft jaw until you hear the "click" sound.

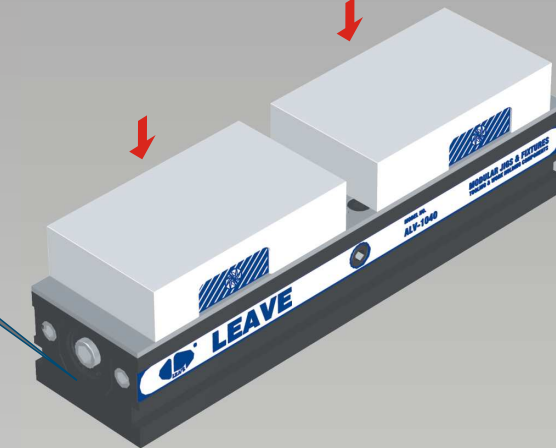

5 Move the moveable soft jaw according to the arrow pointing direction until you hear the "click".

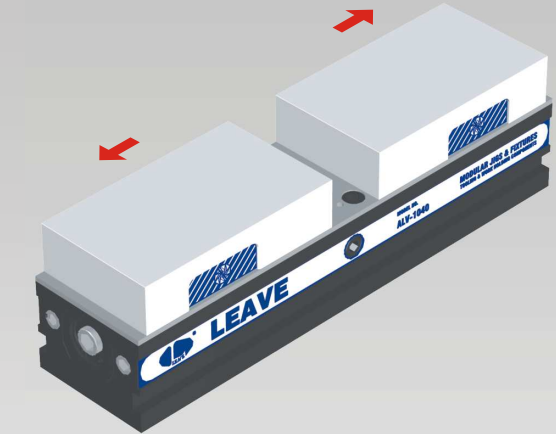

6 After making the soft jaw to the shape you want, the workpiece is clamped.

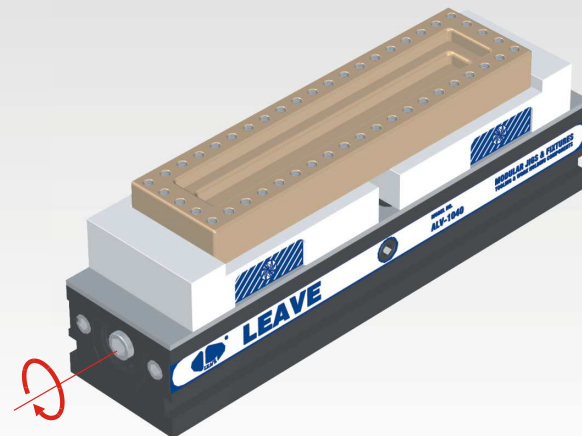

ALV HIGH STRENGTH ALUMINUM LINE UP VISE

Application for Quick Fixture Base

- Quickly convert the vise into a fixture base.
- Tightening the vise screw locks the fixture base in place.

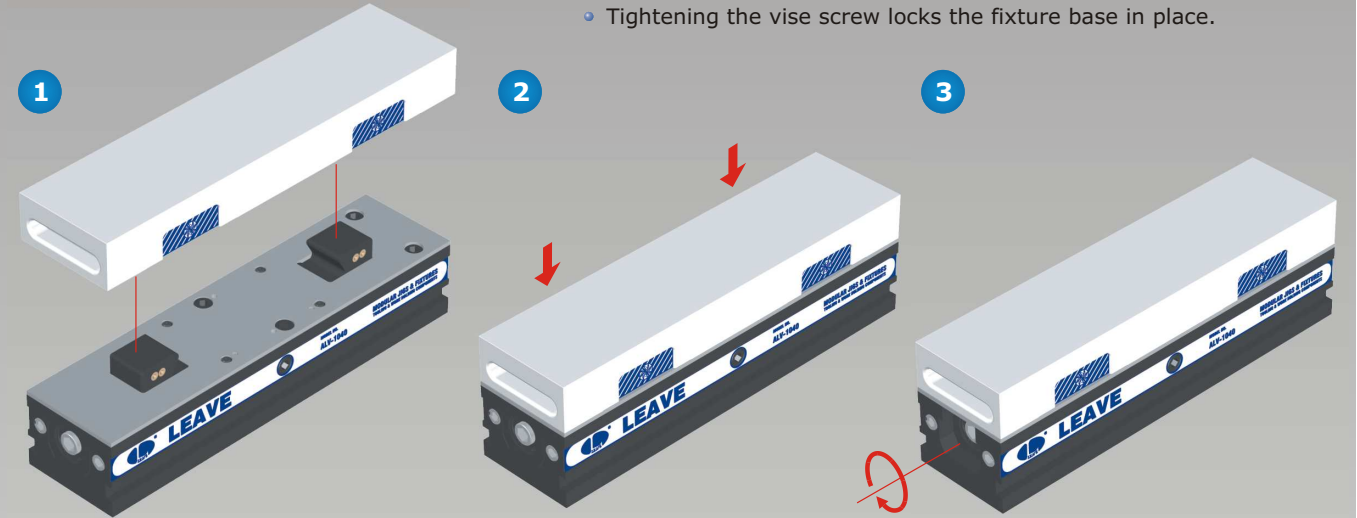

Assembled

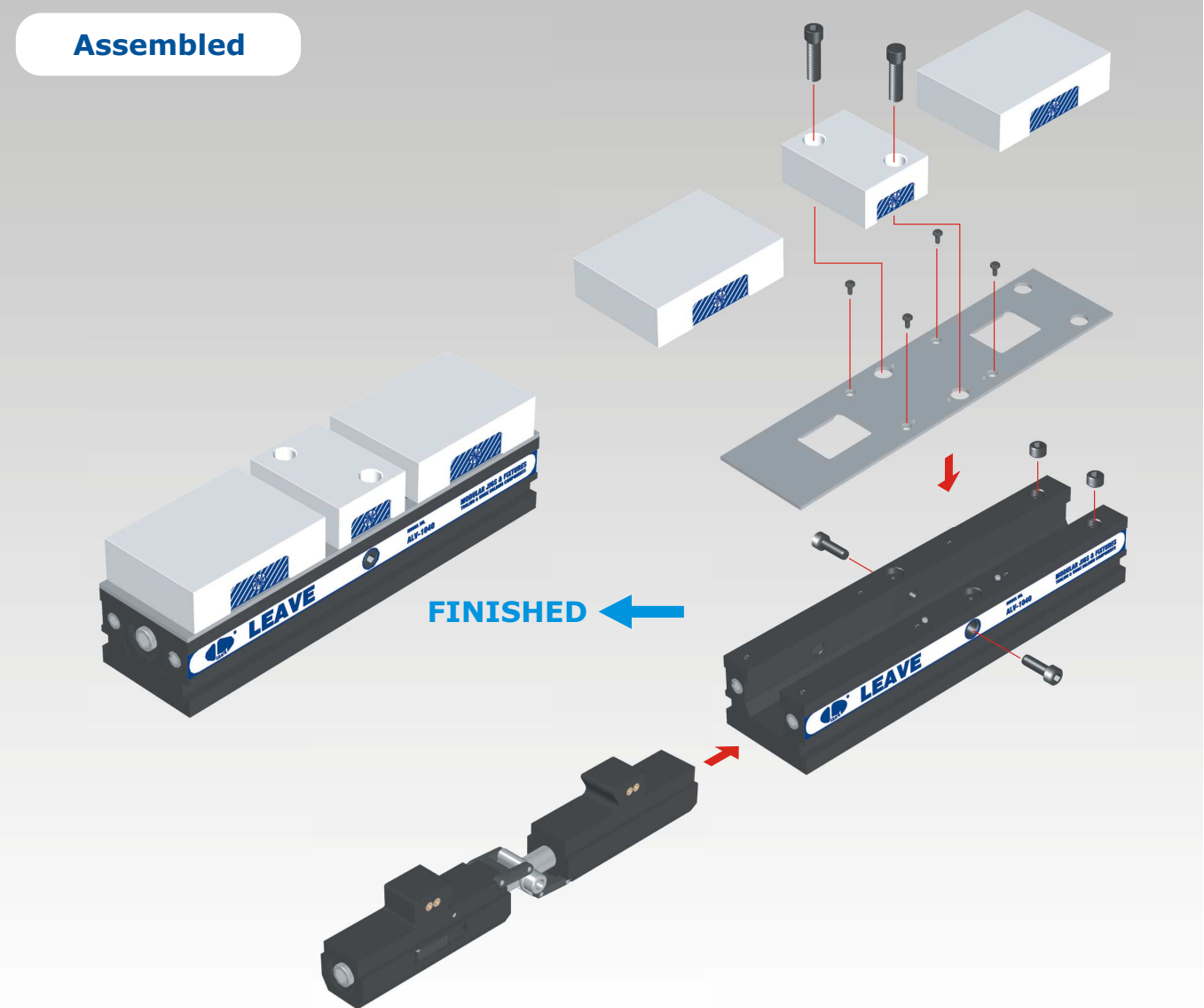

- BP
- BPA
- BC
- CP
- SU
- PT
- SVF
- ALV**
- OK-VISE
- OTHER

Column for Technical Data



ALV

HIGH STRENGTH ALUMINUM LINE UP VISE

- Material: High strength aluminum A7075 (Hard coat surface)
Tool steel (Hardness: over HRC 55°)
- Application: Ideal for aluminum or irregular shaped work pieces.

Specification

MODEL NO.	A	B	C	F	G	H	J	kg
ALV-0620-0	64	60	200	199	43	21	72.0	3.8
ALV-1030-0	76	100	300	299	66	45	104.0	9.8
ALV-1040-0	76	100	400	399	66	45	149.0	14.0
ALV-1550-0	95	150	500	499	89	49	198.5	25.0

Quick Fixture Base

MODEL NO.	A	B	C	D	E	G	kg
ALV-0620-58	199	60	21	3	20.5	72.0	0.75
ALV-1030-58	299	100	45	20	31.5	104.0	3.25
ALV-1030-58H			54	29			4.00
ALV-1030-58W	299	150	45	20	31.5	104.0	5.10
ALV-1030-58WH			54	29			6.20
ALV-1040-58	399	100	45	20	59.0	149.0	4.50
ALV-1040-58H			54	29			5.42
ALV-1040-58W	399	150	45	20	59.0	149.0	6.63
ALV-1040-58WH			54	29			7.30
ALV-1550-58	499	150	49	19	61.3	198.5	10.20
ALV-1550-58H			59	29			11.80
ALV-1550-58W	499	200	49	19	61.3	198.5	13.60
ALV-1550-58WH			59	29			15.80



ALV

HIGH STRENGTH ALUMINUM LINE UP VISE

- Material: High strength aluminum A7075 (Hard coat surface)
Tool steel (Hardness: over HRC 55°)
- Application: Ideal for aluminum or irregular shaped work pieces.

Specification

MODEL NO.	B	F	G	H	J	K	M	N	O	kg
ALV-1030-C-0	100	299	66	45	104.0	335	250	278	200	47.0
ALV-1040-C-0	100	399	66	45	149.0	435	250	278	200	60.7
ALV-1550-C-0	150	499	89	49	198.5	545	300	338	250	104.0

※ ALL SIZE BASE PLATES ARE AVAILABLE FOR THE ALV VISE.

BP

BPA

BC

CP

SU

PT

SVF

ALV

OK-VISE

OTHER

Column for Technical Data



ALV

HIGH STRENGTH ALUMINUM LINE UP VISE

- Material: High strength aluminum A7075 (Hard coat surface)
Tool steel (Hardness: over HRC 55°)
- Application: Ideal for aluminum or irregular shaped work pieces.

Specification

MODEL NO.	A	B	C	F	G	H	J	P	kg
ALV-0620-1	64	60	200	93.0	43	21	82	0-14	3.2
ALV-1030-1	76	100	300	140.0	66	39	114	0-20	9.2
ALV-1040-1	76	100	400	170.0	66	39	149	15-45	13.0
ALV-1550-1	95	150	500	207.5	89	49	176	35-80	24.5

Extended Movable Soft Jaw

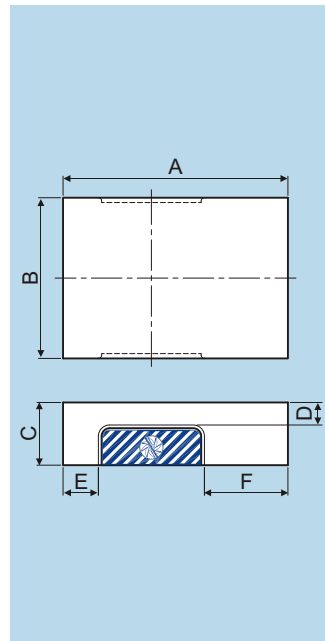

MODEL NO.	A	B	C	D	E	F	kg
ALV-0620-55	93.0	60	21	3	16	34.0	0.24
ALV-0620-55H			31	13			0.35
ALV-0620-55W	93.0	80	21	3	16	34.0	0.38
ALV-0620-55WH			31	13			0.56
ALV-1030-55	140.0	100	39	14	22	52.0	1.30
ALV-1030-55H			54	29			1.90
ALV-1030-55W	140.0	150	39	14	22	52.0	2.10
ALV-1030-55WH			54	29			2.96
ALV-1040-55	170.0	100	39	14	37	67.0	1.62
ALV-1040-55H			54	29			2.38
ALV-1040-55W	170.0	150	39	14	37	67.0	2.60
ALV-1040-55WH			54	29			3.60
ALV-1550-55	207.5	150	49	19	48	70.5	3.36
ALV-1550-55H			59	29			4.04
ALV-1550-55W	207.5	200	49	19	48	70.5	4.48
ALV-1550-55WH			59	29			5.39

ALV

HIGH STRENGTH ALUMINUM LINE UP VISE

- Material: High strength aluminum A7075 (Hard coat surface)
Tool steel (Hardness: over HRC 55°)
- Application: Ideal for aluminum or irregular shaped work pieces.

Specification

MODEL NO.	B	F	G	H	J	K	M	N	O	P	kg
ALV-1030-C-1	100	140.0	66	39	114	335	250	266	200	0-20	44.5
ALV-1040-C-1	100	170.0	66	39	149	435	250	266	200	15-45	56.2
ALV-1550-C-1	150	207.5	89	49	176	545	300	338	250	35-80	102.0

* ALL SIZE BASE PLATES ARE AVAILABLE FOR THE ALV VISE.

- BP
- BPA
- BC
- CP
- SU
- PT
- SVF
- ALV
- OK-VISE
- OTHER

Column for Technical Data



ALV

HIGH STRENGTH ALUMINUM LINE UP VISE

- Material: High strength aluminum A7075 (Hard coat surface)
Tool steel (Hardness: over HRC 55°)
- Application: Ideal for aluminum or irregular shaped work pieces.

Specification

MODEL NO.	A	B	C	D	E	G	H	I	P	kg
ALV-0620-2	64	60	200	75	36	43	21	25.0	0-7.0	3.0
ALV-1030-2	76	100	300	110	60	66	39	44.5	0-10.0	9.0
ALV-1040-2	76	100	400	140	75	66	39	65.0	0-15.0	12.8
ALV-1550-2	95	150	500	185	80	89	49	86.0	0-22.5	24.0

Fixed Jaw

MODEL NO.	A	B	C	D	E	kg
ALV-0620-57	36	60	21	7	2.0	0.10
ALV-0620-57H			31	17		0.15
ALV-0620-57W	36	80	21	7	2.0	0.15
ALV-0620-57WH			31	17		0.23
ALV-1030-57	60	100	39	17	5.5	0.60
ALV-1030-57H			54	32		0.80
ALV-1030-57W	60	150	39	17	5.5	0.90
ALV-1030-57WH			54	32		1.25
ALV-1040-57	75	100	39	17	13.0	0.72
ALV-1040-57H			54	32		1.04
ALV-1040-57W	75	150	39	17	13.0	1.14
ALV-1040-57WH			54	32		1.60
ALV-1550-57	80	150	49	21	15.5	1.45
ALV-1550-57H			59	31		1.75
ALV-1550-57W	80	200	49	21	15.5	2.00
ALV-1550-57WH			59	31		2.40

Movable Soft Jaw

MODEL NO.	A	B	C	D	E	kg
ALV-0620-56	75	60	21	3	16	0.20
ALV-0620-56H			31	13		0.28
ALV-0620-56W	75	80	21	3	16	0.30
ALV-0620-56WH			31	13		0.45
ALV-1030-56	110	100	39	14	22	1.00
ALV-1030-56H			54	29		1.45
ALV-1030-56W	110	150	39	14	22	1.62
ALV-1030-56WH			54	29		2.30
ALV-1040-56	140	100	39	14	37	1.35
ALV-1040-56H			54	29		1.90
ALV-1040-56W	140	150	39	14	37	2.04
ALV-1040-56WH			54	29		2.95
ALV-1550-56	185	150	49	19	48	3.35
ALV-1550-56H			59	29		4.00
ALV-1550-56W	185	200	49	19	48	4.48
ALV-1550-56WH			59	29		5.40

ALV

HIGH STRENGTH ALUMINUM LINE UP VISE

- Material: High strength aluminum A7075 (Hard coat surface)
Tool steel (Hardness: over HRC 55°)
- Application: Ideal for aluminum or irregular shaped work pieces.

Specification

MODEL NO.	B	D	E	G	H	I	K	M	N	O	P	kg
ALV-1030-C-2	100	110	60	66	39	32.5	335	250	266	200	0-10.0	44.5
ALV-1040-C-2	100	140	75	66	39	65.0	435	250	266	200	0-15.0	57.0
ALV-1550-C-2	150	185	80	89	49	86.0	545	300	338	250	0-22.5	100.0

* ALL SIZE BASE PLATES ARE AVAILABLE FOR THE ALV VISE.

- BP
 - BPA
 - BC
 - CP
 - SU
 - PT
 - SVF
 - ALV
 - OK-VISE
 - OTHER
- Column for Technical Data

ALV

**HIGH STRENGTH
ALUMINUM LINE UP VISE**

The locating mounting holes for ALV main body

ALV-0620

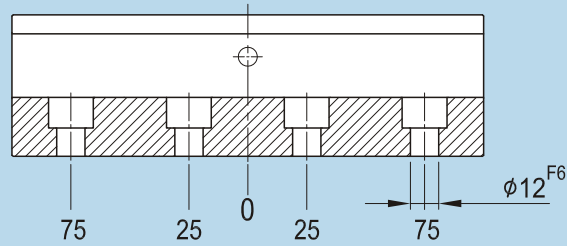

ALV-1030

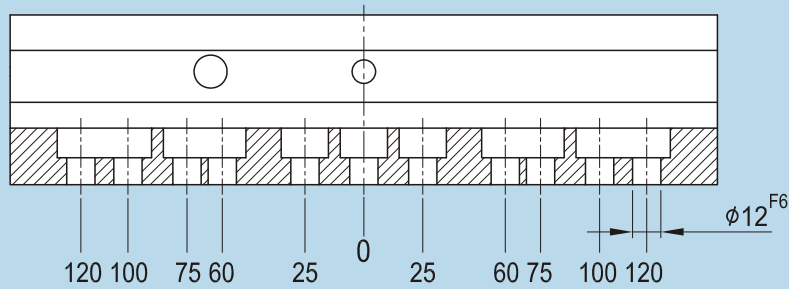

ALV-1040

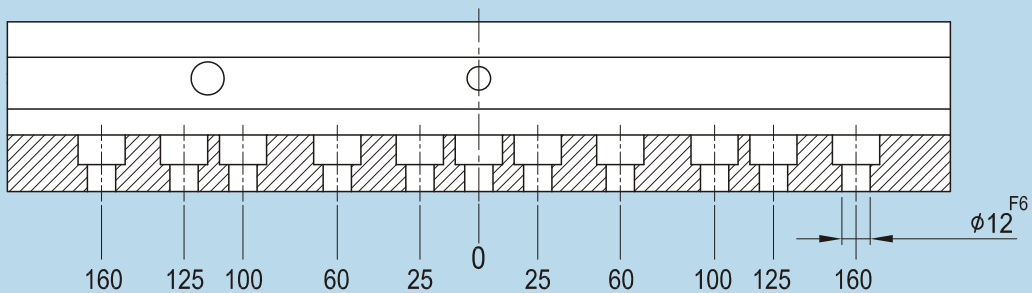

ALV-1550

